



## Flap Valve

### Fig. VA5218

### Application

- ✓ Flange drilled is according to EN1092-2,
- ✓ Working temperature:  $-20^{\circ} \sim 80^{\circ}\text{C}$ ,
- ✓ working pressure: PN10-PN16.

DN	$\varnothing D$		$\varnothing K$		$\varnothing G$		$n-\varnothing d$		A	B	H	L
	PN10	PN16	PN10	PN16	PN10	PN16	PN10	PN16				
DN50	$\varnothing 165$	$\varnothing 165$	$\varnothing 125$	$\varnothing 125$	$\varnothing 99$	$\varnothing 99$	4- $\varnothing 19$	4- $\varnothing 19$	3	19	107	129
DN65	$\varnothing 185$	$\varnothing 185$	$\varnothing 145$	$\varnothing 145$	$\varnothing 118$	$\varnothing 118$	4- $\varnothing 19$	4- $\varnothing 19$	3	19	119	146
DN80	$\varnothing 200$	$\varnothing 200$	$\varnothing 160$	$\varnothing 160$	$\varnothing 132$	$\varnothing 132$	8- $\varnothing 19$	8- $\varnothing 19$	3	19	128	150
DN100	$\varnothing 220$	$\varnothing 220$	$\varnothing 180$	$\varnothing 180$	$\varnothing 156$	$\varnothing 156$	8- $\varnothing 19$	8- $\varnothing 19$	3	19	141	158
DN125	$\varnothing 250$	$\varnothing 250$	$\varnothing 210$	$\varnothing 210$	$\varnothing 186$	$\varnothing 186$	8- $\varnothing 19$	8- $\varnothing 19$	3	19	151	165
DN150	$\varnothing 285$	$\varnothing 285$	$\varnothing 240$	$\varnothing 240$	$\varnothing 211$	$\varnothing 211$	8- $\varnothing 23$	8- $\varnothing 23$	3	19	169	168
DN200	$\varnothing 340$	$\varnothing 340$	$\varnothing 295$	$\varnothing 295$	$\varnothing 266$	$\varnothing 266$	8- $\varnothing 23$	12- $\varnothing 23$	3	20	200	185
DN250	$\varnothing 405$	$\varnothing 405$	$\varnothing 350$	$\varnothing 355$	$\varnothing 319$	$\varnothing 319$	12- $\varnothing 23$	12- $\varnothing 28$	3	22	250	245
DN300	$\varnothing 460$	$\varnothing 460$	$\varnothing 400$	$\varnothing 410$	$\varnothing 370$	$\varnothing 370$	12- $\varnothing 23$	12- $\varnothing 28$	4	25	320	305
DN400	$\varnothing 580$	$\varnothing 580$	$\varnothing 515$	$\varnothing 525$	$\varnothing 480$	$\varnothing 480$	16- $\varnothing 28$	16- $\varnothing 31$	4	28	408	356
DN500	$\varnothing 715$	$\varnothing 715$	$\varnothing 620$	$\varnothing 650$	$\varnothing 582$	$\varnothing 609$	20- $\varnothing 28$	20- $\varnothing 34$	4	32	503	415
DN600	$\varnothing 840$	$\varnothing 840$	$\varnothing 725$	$\varnothing 770$	$\varnothing 682$	$\varnothing 720$	30- $\varnothing 31$	20- $\varnothing 37$	5	36	586	443

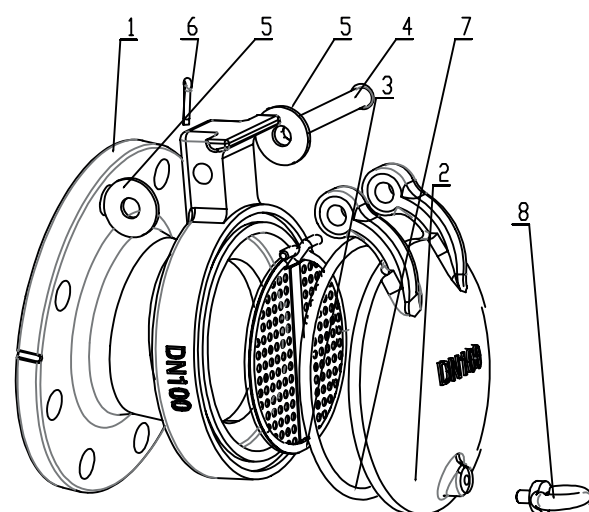

Ltem	Parts Name	Material	Quantity
1	Body	GGG50	1
2	Bonnet	GGG50	1
3	Screen	SS304	1
4	Pin	SS304	1
5	Metal gaskrt	SS304	2
6	Cilp	SS304	1
7	Gasket	EPDM	1
8	Lifting ring	CARBON STEEL	1

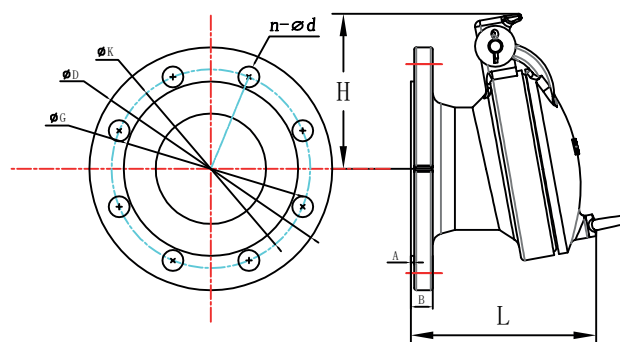

#### Notes

Designs, materials and specifications shown are subject to change without notice due to the continuous development of our products.